

Taycol Paxolin end-plates

Taycol end-plates act as bearings for the shaft. They wear after long use but can easily be replaced by cutting these shapes out of 1/16" paxolin. Cut the shaft hole slightly undersize and lap it to get a really smooth rotation. Note that some motors have multiple layers of paxolin...

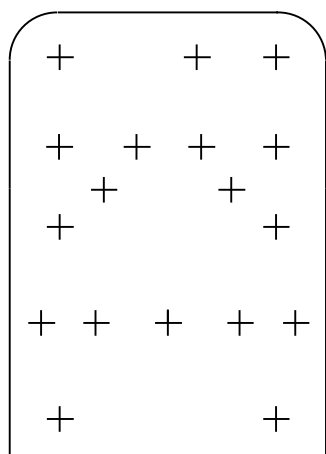

Standard End-Plate

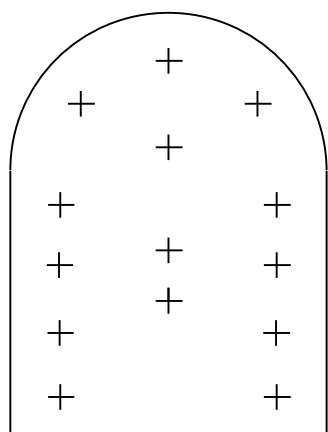

Small Motor End-Plate

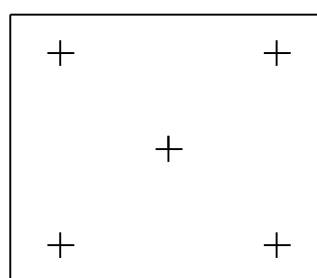

Common Front-Plate

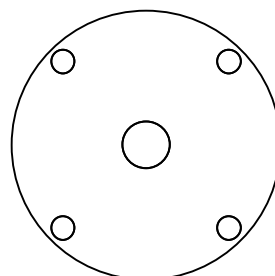

Large Motor Shaft Bearing

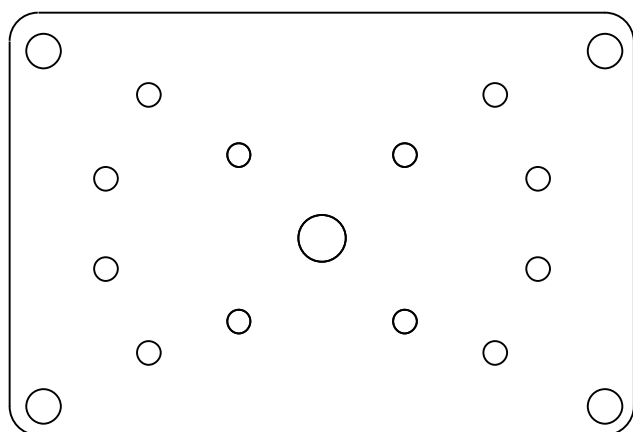

Large Motor End-Plate

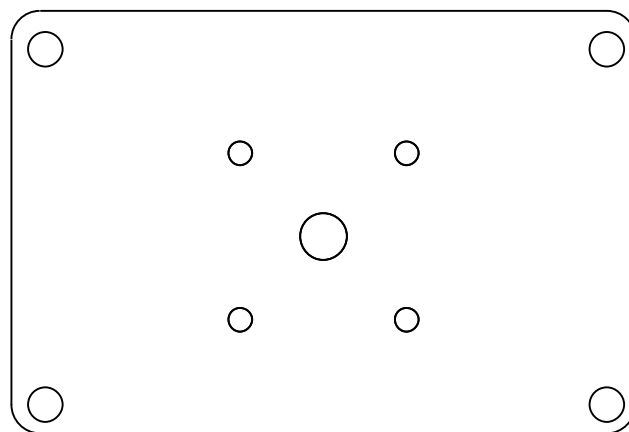

Large Motor Front-Plate